

# 21.05 Acres Pasture Land and Wooded Lincoln County, GA

- \* Pasture land
- \* Wooded land
- \* Long Paved road frontage
- \* Electric and phone
- \* Just South of Lincolnton
- \* Close to Augusta
- \* \$94,725.00



**Description:** This tract is really pretty slightly rolling terrain. It is a nice combination of pasture land and hardwoods forests. There is an excellent pond site. This is a truly bucolic setting and is surrounded by really nice properties.



Brashear Realty Corp.  
513 Broad Street  
Augusta, Georgia 30901

**Tel: (706)-722-4308**  
**Fax: (706)-722-4374**

<http://www.georgiacountry.com>  
e-mail: [tice@brashearrealty.com](mailto:tice@brashearrealty.com)

Great Location near Lincolnton!

Information contained herein has been collected from reliable resources however it is not guaranteed. Information should be verified from independent resources.

©Copyright Brashear Realty Corporation 2013



Pasture Land

Gate Leading into  
the Property



Pasture Land



Description: This property is ideally located in Lincoln County within a mile of the city of Lincolnton, Georgia. It features a great mix of pasture land and rolling hardwood forests. The woodland is predominantly hardwoods with some pine. There is some fencing. The property is surrounding by tracts with nice homes and rolling pastures.

Directions: From Augusta follow Washington Road towards Lincolnton. At Pollard's Corner continue on Washington Road ( Highway 47 ) for a distance of 18 miles into Lincolnton. When you get into the city of Lincolnton, look for Whiterock Road on your left. Turn left onto Whiterock Road for approximately one mile. The property will be on your left

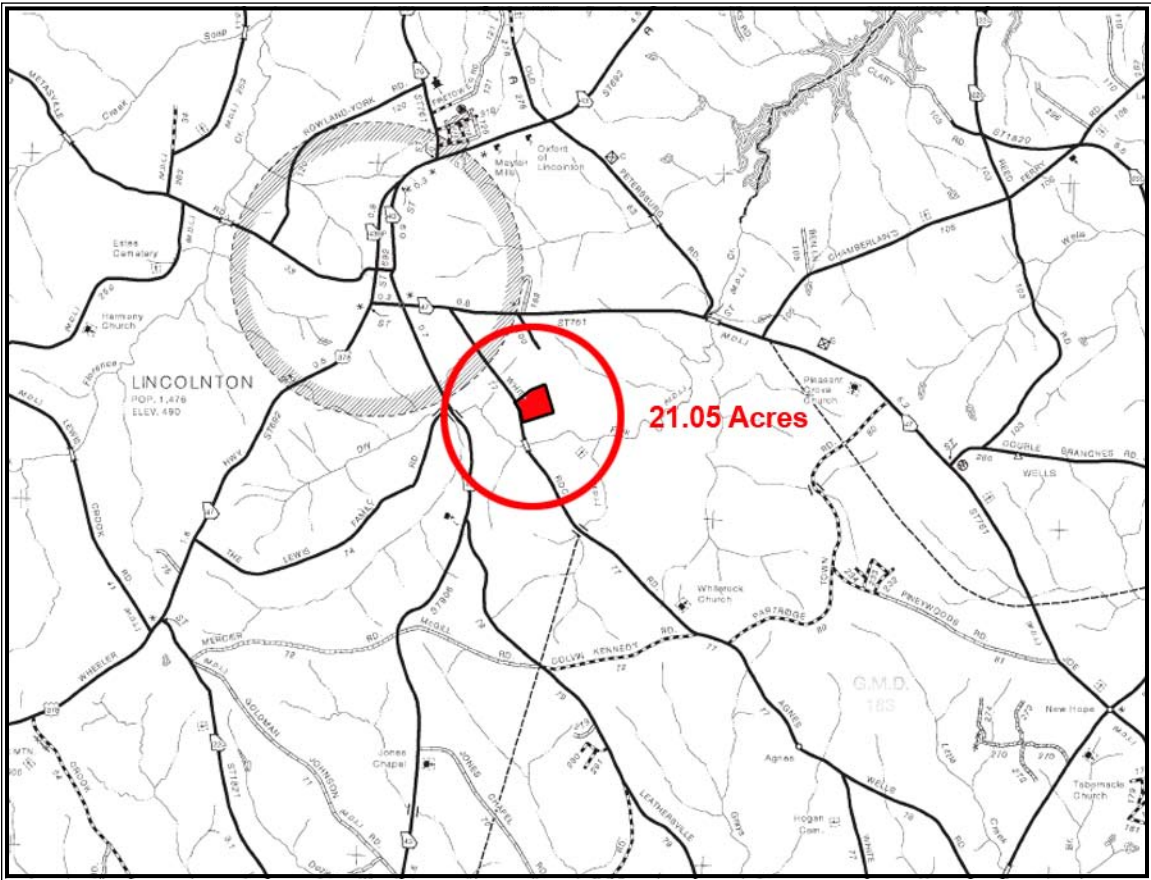

Aerial Photograph



Topography Map

